

Michele Moreno graduated in Architecture with honors in 2001 from I.U.A.V. University of Venice, developing an experimental thesis entitled *Escape through space and time. Among the folds of an invisible city and its interrupted dream* (supervisor prof. F. Purini). In 2001 he participated in the *Advanced Course & Workshop on aesthetics and new forms of sociality* (director prof. Roberto Masiero; coordinating artist Ennio Chiggio). In 2006 he obtained his Ph.D in Architectural and Urban Design at the Politecnico di Milano, taking part in several international workshops, including the *Landscape and Urban Design* workshop at N.Y.I.T. (New York Institute of Technology, supervising prof. M. Schwarting, New York, USA) and the *Landscape Design* internship at the Oxford Brooks University (supervising prof. Roger Simmonds, Oxford, England). In 2009 he obtained a post-doctoral research fellowship at the Politecnico di Milano, developing research on sustainable design entitled *Transformation, substitution, maintenance. Geography and metabolic evolution, the architectural and urban project for the shape of the net-city*.

He collaborated with the national academic research M.U.R.S.T. 2003 with a project entitled *The Space of the Ecclesia* within the research *New Architectures and services for the sustainable development of metropolitan areas: Mestre-Terraglio*, coordinated by prof. arch. S. Bisogni and prof. F. Purini. In 2007 he worked for Progresdec Research, founded by the European Community in collaboration with the DiAP in Milan and the municipalities of Canicatti and Madrid.

His research vision is focused on the relationship between architecture and geography and on the re-elaboration of the concept of *ground* in Architecture within its city and environment. His investigation proceeds through a specific multidisciplinary methodology: the design of the *ground* becomes a relevant opportunity to define a *common space* in which to re-define innovative *sustainable architectural languages*. His publication, entitled *Groundscape Geo-urban transcriptions and expanded archi-tectonics*, defines the main formal structures of the complexity of the site and also re-discovers the latent potentialities of the architecture in terms of *operative topography, cultural nature, and ecological thickness*.

Michele Moreno has lectured in several international universities, including N.Y.I.T. of New York-Usa, ETSA of Seville-Spain, Tehran University-Iran, Technical University of Istanbul-Turkey, Polytechnic University of Bari-Italy, University of Greenwich in London-UK and I.U.A.V. in Venice-Italy. Michele Moreno combines practice design with academic research and didactic activity within the *A.U.I.C (Architecture Urban Planning Construction Engineering of the Polytechnic of Milan)* DASTU Department (*Department Architectural and Urban Studies*), joining the laboratory *Measure and scale MSLab* coordinated by prof. A. Contin.

He has participated in several international competitions, winning awards and obtaining publications, including the competition for the *Piazzale Stazione di Belluno, 2018 Italy* (short-listed finalist), *Ephemeral Structures in Athens, 2004 Open Air Theater* (first place) and has exhibited his work at the *Athens-scape* exhibition in several international galleries and cities such as the RIBA Gallery in London, Fondation Hellenique in Paris and Hangar Bicocca in Milan. In 2006 he was selected to participate in the *X International Architecture Exhibition* of the Venice Biennale, in regards to the main topic *City, Architecture and society*, curated by Richard Burdett, with a project entitled *Sacred You* made for the pavilion *Italia-y-2026, Invito a VeMa*, curated by F. Purini.

He currently lives and works between Milan and Lugano.

Current employment

Ph.D. Architect, Principal *Studio Michele Moreno Architect*, Milan
Adjunct professor *Architectural Design* since 2006, A.U.I.C. Architecture Urban Planning Construction Engineering Politecnico di Milano

Education and training

- 2015 License to practice Safety Coordinator in construction sites
A.U.I.C. Politecnico di Milano
- 2009 Post-Doctoral research *Transformation, substitution, maintenance. Geography and metabolic evolution, the architectural and urban project for the shape of the net-city.*
A.U.I.C. Politecnico di Milano
- 2007 Research Progresdec of the European Community, with the Municipality of Canicattì and Madrid. Policies of ESS (European space development scheme that concerns the common objectives regarding the development of the territory of the European Union).
A.U.I.C. Politecnico di Milano
- 2002-2005 PhD in Architectural and Urban Design Evaluation with merit, XVII cycle, , thesis in *Geo-Archi-Tectura. Between critical dislocation and rooting* , supervisor prof. F. Purini, cord. prof. E. D'Alfonso. A.U.I.C. Politecnico di Milano
- 2004 Workshop in *Landscape and Urban Design* in N.Y.I.T. (New York Institute of Technology), supervisor prof. M. Scwharting. N.Y.I.T. New York, USA
- 2003 Research M.U.R.S.T. *The Space of the Ecclesia* within academic and national research *New Architectures and services for the sustainable development of metropolitan areas: Mestre-Terraglio*, cord. national prof. arch. S. Bisogni, prof. Franco Purini. I.U.A.V. in Venice.
- 2003 Workshop in *Landscape Design* in Oxford Brooks University, supervisor prof. Roger Simmonds. Oxford Brooks University, UK
- 2002 License to practice n° 17230 O. A.P.P.C. Milano
Professional qualification outdated at the I.U.A.V. in Venice
- 2002 L.I.P.A.U. International Laboratory of Architectural and Urban Design: *Ancient cities, modern architecture.* Bergamo, A.U.I.C. Politecnico di Milano
- 2001 MAs in Architecture with honors in 2001 at the I.U.A.V. (University Institute of Architecture of Venice) developing an experimental project entitled *Escape through space and time. Among the folds of an invisible city and its interrupted dream*, with supervisor prof. Franco Purini.
- 2001 *Advanced Course & Workshop on aesthetics and new forms of sociality*, proff.: M. Bertolini, L. Cantoni, M. Casamonti, G. Fabbri, P. Lorenz, M. Manzelle, S. Pittini, U. Trame; director Roberto Masiero; cord. Ennio Chiggio.

Academic activity and research

- 2018 -19 *Morphological and Typological Characters of Architecture*, Master's degree program, Laboratory Architectural Design III.
A.U.I.C. Politecnico di Milano
- 2017 -18 *Morphological and Typological Characters of Architecture*, Master's degree program Laboratory Architectural Design III.
A.U.I.C. Politecnico di Milano
- 2017 Scientific and didactic organization of international workshop in New York City: *Metabolism of a City*, with proff. A. Contin, Ed Wall, Final Laboratory.
A.U.I.C. Politecnico di Milano and N.Y.I.T New York
- 2016 Scientific and didactic organization of international workshop in New York City: *Metabolism of a City*, with proff. A. Contin, Ed Wall, Final Laboratory.
A.U.I.C. Politecnico di Milano and N.Y.I.T New York
- 2015 Scientific and didactic organization of international workshop in New York City: *Metabolism of a City*, with proff. A. Contin, Ed Wall, Final Laboratory.
A.U.I.C. Politecnico di Milano and N.Y.I.T New York

- 2015 Scientific and didactic organization of international workshop in Tehran, Teheran Cee International workshop, with prof. A. Contin.
A.U.I.C. Politecnico di Milano and Tehran University
- 2014-15 *Architectural Design III*, 1st Semester, Bachelor's degree program DM 270/04 in Architecture
A.U.I.C. Politecnico di Milano
- 2014 Scientific and didactic organization of international workshop Metropolitan Architecture, with prof. A. Contin.
A.U.I.C. Politecnico di Milano
- 2014 International workshop MIAW 2014 del Politecnico di Milano, with proff. A. Contin, G. Santamaria and M. Scwharting. A.U.I.C. Politecnico di Milano
- 2014 Scientific and didactic organization of international workshop: *Donana Out of the City*, with prof. A. Contin and with prof. D. S. Sanchez E.T.S.A. University of Seville.
- 2013-14 *Architectural Design III*, Bachelor's Degree Program DM 270/04 in Architecture.
A.U.I.C. Politecnico di Milano
- 2013 Scientific and didactic organization of international workshop in New York City: *Metabolism of a City*, with proff. A. Contin, Ed Wall, Final Laboratory.
A.U.I.C. Politecnico di Milano and N.Y.I.T New York
- 2013 Scientific and didactic organization of international workshop: *Donana Out of the City*, with prof. A. Contin and prof. D. S. Sanchez E.T.S.A. University of Seville.
- 2012-13 *Architectural Design III*, Bachelor's Degree Program DM 270/04 in Architecture.
A.U.I.C. Politecnico di Milano
- 2012 Scientific and didactic organization of international workshop: *Donana Out of the city*, with prof. A. Contin and prof. D. S. Sanchez E.T.S.A. University of Seville.
- 2011 Scientific and didactic organization of international workshop *Algorithm re-thinking Landscape Urbanism through parametric –(re)generative strategies*, 4CFU, in Palanzano, with municipality of Parma. Sponsors: *Comune di Palanzano, Provincia di Parma, Consorzio Parmigiano Reggiano, Consorzio Prosciutto di Parma*. DiAP Politecnico di Milano, ITU Istanbul, E.T.S.A.S. Sevilla, N.Y.I.T. New York, Kingston University London, Alcalà de Henares Madrid.
- 2010-11 *Landscape Architecture*, Bachelor's degree program DM 270/04 in Architecture, *Architectural Design III*. School of Architecture and Society, Politecnico di Milano
- 2009-10 *Landscape Architecture*, Bachelor's degree program DM 270/04 in Architecture, *Architectural Design III*. School of Architecture and Society, Politecnico di Milano
- 2008-09 *Landscape Architecture*, Bachelor's degree program DM 270/04 in Architecture, *Architectural Design III*. School of Architecture and Society, Politecnico di Milano
- 2007-08 *Landscape Architecture*, Bachelor's degree program DM 270/04 in Architecture, *Architectural Design III*. School of Architecture and Society, Politecnico di Milano
- 2007 Scientific and didactic organization of international workshop and Symposium: *New Dimension for inner Urban landscapes*, with prof. A. Contin and prof. G. Santamaria. Do-PAU Ph.D. program Coordinator prof. E. D'Alfonso.
- 2006-17 MSLab, Measure and Scale Laboratory, DASTU Department, Polytechnic of Milan, coordinated by prof. Antonella Contin.
- 2004-05 Member of the scientific committee: International Symposium Bari Studies for the Metropolis with Do-PAU Ph.D. program Coordinator prof. E. D'Alfonso.

Seminars, conferences and committees

- 2019 Member of the Selection Board, comparative procedure n. 103/2018 School of A.U.I.C., Politecnico di Milano.

- 2018 Lecture: *Open Architecture Didactic*. Seminar VII Forum Proarch Milano 16-17 november 2018.
- 2018 Member of the Selection Board, comparative procedure n. 101/2018 School of A.U.I.C., Politecnico di Milano.
- 2018 Chairman: seminar *Tracce di libertà, l'architettura nel carcere. II Casa di Reclusione Milano-Bollate, 22.10.2018.*
- 2017 Lecture: *Piazzale stazione di Belluno*. Theater of municipality in Belluno.
- 2017 Chairman: *Symposium Metabolism of a City: value and image*, N.Y.I.T. New York.
- 2017 Lecture: *Uncanny Metropolis*, A.U.I.C., Politecnico di Milano.
- 2016 Lecture: *Documento preliminare Progetto Spazi Pubblici in Salvarosa*. Castelfranco Veneto with Mas arch. Chiara Pradel.
- 2016 Lecture: *New York Uncanny*. Architectural Design, proff. E.Wall, A.Contin, M.Nastri, A.U.I.C., Politecnico di Milano.
- 2016 Lecture: *New built form type*. Symposium *Urban Landscapes and Metropolitan Regions*. N.Y.I.T. New York.
- 2015 Lecture: *Process and Time*. Laboratory Architectural Design II prof. A. Chiesa, A.U.I.C., Politecnico di Milano.
- 2015 Lecture: *Geography Architecture Information*. International workshop and seminar Tehran Cee.
- 2015 Lecture: *Peter Eisenman, from decomposition to spacing. Elements of Architectural Typology*, prof. A. Contin, A.U.I.C., Politecnico di Milano.
- 2013 Lecture: *Ground Project*. Lab III prof. A. Contin, A.U.I.C., Politecnico di Milano.
- 2013 Lecture: *Spazio di Distrazione. Elements of Architecture* prof. A. Contin, Politecnico di Milano.
- 2013 Lecture: *Reading and movement*. Lab. Architectural Design, prof. A. Chiesa, Politecnico di Milano.
- 2012 Seminar: *Deep orientation in architectural and urban research* for the III International Symposium_ *Dareterra 2012. New sustainable models for the urban growth - Abitare la Tecnica*. Lab. *Misure e Scale*, Municipality of Milano, DiAP and PhD program PAU, Politecnico di Milano.
- 2012 Seminar: *Introduction e Presentation of the research results to local authorities, in international workshop Algorithmap re-thinking Landscape Urbanism trough parametric -(re)generative strategies*. Palanzano (Pr) Valle dei Cavalieri, with the municipality of Parma.
- 2011 Seminar: *A plan for research. The reasons for the meeting*, in II International Symposium *Dareterra 2011 New sustainable models for the urban growth - Abitare la Terra*. Lab. *Misure e Scale* (DiAP), municipality of Milano, DiAP and Ph.D program PAU, Politecnico di Milano.
- 2010 Seminar: 1st International Symposium *Dareterra 2010 New sustainable models for the urban growth*. Lab. *Misure e Scale* (DiAP), Municipality of Milano, DiAP (Polimi) and PhD program PAU Politecnico di Milano.
- 2009 Seminar, *Rehabilitation of urban edges and sustainability of the identity*, within 1st Architecture and Urbanism International workshop *Sustainability of the identity - Bahia De Cadiz, Spain*, with ETSAS, Escuela Tecnica Superior de Sevilla.
- 2008-09 Seminar: *Trasformazione, Sostituzione, Manutenzione. Geografia ed evoluzione metabolica, il progetto architettonico ed urbano per la forma della net-city*. Politecnico di Milano.
- 2008 Lecture: *Complexity is a contradiction?*. Do-PAU Ph.D program *International Symposium and Workshop Measure and scale. Big Containers and Inner Landscape: new paradigms of the net-city*, Politecnico di Milano.
- 2007 Seminar: *Il disegno dello spazio Urbano. VEMA per ripensare la densità e la forma*, Reggio Emilia.
- 2006 Lecture: *Bigbox, Megaform and morphotype*. Do-PAU Ph.D *International Symposium: Milano Malpensa. The urban region and the space of flows*. PAU. Politecnico di Milano and S.E.A. *Aeroporti di Milano*.
- 2006 Conference: *IV International Convention of Architecture and Liturgy in the Twentieth Century. Comparing experiences*. Venezia 26-27 ottobre 2006.
- Conference: *La città metropolitana e la scala architettonica*, exhibition: *Bari Studi per la Metropoli*. PAU, prof.

- 2005 E.D'Alfonso, Municipality of Bari. Sponsors: *Confindustria Bari, Ance Bari, Ance Puglia*.
- 1996 Conference: *La città ed il territorio*, Politecnico di Bari, Hall Theater Petruzzelli, Bari.

Master's and Bachelor's thesis supervisor and co-supervisor

- 2015 Master's thesis: *Groundscapes - Conversations Between Architecture and Ground in the Italian Context*, stud. Crepaldi Giorgia, supervisor prof. Michele Moreno, Politecnico di Milano, february 2015.
- 2015 Master's thesis: *Informal Codex - a multiscalar strategy for the informal Buenos Aires*, stud. Bianca Maria Teti, supervisor prof. Michele Moreno. Politecnico di Milano, july 2015.
- 2015 Bachelor's thesis: *Out of(n) Time. A project regarding the future of tomorrow. A floating city due to the sudden climate changes and water level rises*, stud. Federico Fauli, supervisor prof. Michele Moreno, Politecnico di Milano, july 2015.
- 2015 Bachelor's thesis: *Eco Urban Design Multiscalar Approach To Contemporary Urbanism*, stud. Salali Doruk, supervisor prof. M. Moreno, Politecnico di Milano, july 2015.
- 2015 Bachelor's thesis: *[ev] empathetic vibrations*, stud. Can Aksan, supervisor prof. Michele Moreno, Politecnico di Milano, september 2015.
- 2015 Bachelor's thesis: *Linear Planning Inflections - A matter of scale*, stud. Toffalini Davide, supervisor prof. M. Moreno, Politecnico di Milano, september 2015.
- 2015 Master's thesis: *New York 2020*, stud. Filippo Foschi, supervisor prof. Michele Moreno, Politecnico di Milano, december 2015.
- 2014 Bachelor's thesis: *Landscape Urbanism*, stud. Denis Gachev; supervisor prof. Michele Moreno; Politecnico di Milano, february 2014.
- 2014 Master's thesis: *Geomorfologia Urbana _ Ancona, strategie metaboliche tra suoli geografici e misura urbanaa*, stud. Anconetani Luca, supervisor prof. Michele Moreno, Politecnico di Milano, april 2014.
- 2014 Bachelor's thesis: *SYN- Synchronism Between Spatial image and Natural Light*, stud. Gun Ceren, supervisor prof. Michele Moreno, co-supervisor prof. Giancarlo Floridi, Politecnico di Milano, September 2014.
- 2014 Master's thesis: *Informal identity Diagrammatic Synthesis, Method, process and transformation*, stud. Marina Martello, supervisor prof. Michele Moreno, Politecnico di Milano, december 2014.
- 2013 Bachelor's thesis: *Informe. Origin and process of the form*, stud. Filippo Foschi, supervisor prof. Michele Moreno, Politecnico di Milano february 2013.
- 2013 Bachelor's thesis: *UrbanTecture*, stud. Bernardo Rossi, supervisor prof. Michele Moreno; Politecnico di Milano, february 2013.
- 2013 Bachelor's thesis: *Paesaggi Informi*, stud. Santucci Eleonora and Raimondi Elena, supervisor prof. Michele Moreno, Politecnico di Milano, september 2013.
- 2013 Bachelor's thesis: *Landscape Architecture, writing spaces*, stud. Drapelli Anna and Galazzini Giulia, supervisor prof. Michele Moreno, Politecnico di Milano, september 2013.
- 2012 Bachelor's thesis: *Landform Architecture - Living the fold and new figures of urban design*, stud. Teti Bianca Maria, supervisor prof. Michele Moreno, Politecnico di Milano, july 2012.
- 2012 Bachelor's thesis: *ArchiPoesis*, stud. Talu Merve Cigdem, supervisor prof. Michele Moreno, Politecnico di Milano, september 2012.
- 2011 Bachelor's thesis: *Diagram of space. New logic of the figure and strategy of urban design*, stud. Elena Matossi l'Orsa, Anna Morani, Davide Morra, supervisor prof. Michele Moreno, Politecnico di Milano.
- 2010 Bachelor's thesis: *Form and complexity*, stud. Ugo Gorgone, supervisor prof. A. Contin; co-supervisor prof. Michele Moreno, Politecnico di Milano.
- 2009 Master's thesis: *Madrid casa de campo : urban portraits and ground densification*, stud. Federico Mistò, supervisor prof. Ernesto D'Alfonso, co-supervisor proff. Antonella Contin, Michele Moreno, Politecnico di Milano.
- 2009 Master's thesis: *Milano Montecity Rogoredo : water strategies for a new urban limit*, stud. Francesco Martinelli, supervisor prof. Ernesto D'Alfolso, co-supervisor prof. Michele Moreno, Politecnico di Milano.
- 2009 Master's thesis: *Milan Rogoredo South Agricultural Park : a water met scape*, stud. Massimiliano Ciavatta, supervisor prof. E. D'Alfonso, co-supervisor prof. Michele Moreno, Politecnico di Milano.
- 2008 Master's thesis: *London Stratford : new spatial urban territories between land value, urban neighborhood and Net-City*, stud. Daniele Striccoli, sup. prof. Ernesto D'Alfonso, co-supervisor prof. Michele Moreno, Politecnico di Milano.
- 2008 Master's thesis: *London Stratford measure of a new urbanity between local images and global instances*, stud. Diego Vergani, sup. prof. E. D'Alfonso, co-sup. prof. Michele Moreno, Politecnico di Milano.
- 2008 Master's thesis: *Londra-Stratford : figures, margins, morphology. Connective soils and morphological characters*, stud. Annunziata Fabio, Mattia Tanzi, sup. prof. E. D'Alfonso, co-sup. prof. Michele Moreno, Politecnico di Milano.
- 2008 Master's thesis: *Londra Stratford, opportunity for an urban escape*, stud. Matteo Bosio, sup. prof. E. D'Alfonso, co-supervisor prof. Michele Moreno, Politecnico di Milano.

- 2008 Master's thesis: *Nodo stazione Londra Stratford : figure urbane tra dimensione urbana e scala territoriale*, stud. A. Pantuso, sup. prof. E. D'Alfonso, co-sup. prof. Michele Moreno, Politecnico di Milano.
- 2007 Master's thesis: *London, Stratford: new territorial and urban figures*, stud. Alba Bici, Sliman Darawshi, sup. prof. E. D'Alfonso, co-sup. prof. Michele Moreno, Politecnico di Milano.
- 2007 Master's thesis: *Matter unveiled between geographical tension and urban form: figures of ground for new spaces of interaction*, stud. Daniele William Re, sup. prof. E. D'Alfonso, co-sup. prof. M. Moreno, Politecnico di Milano.
- 2007 Master's thesis: *Architectural microscopies in geographical macroscopies: new Stratford London City*, stud. G. Mazzoleni, sup. prof. E. D'Alfonso, co-sup. prof. Michele Moreno, Politecnico di Milano.
- 2007 Master's thesis: *New Stratford City. Stratifications of grounds between urban measurement and geographical writing*, stud. Fabio Chiocchetti, Andrea Padovani, sup. prof. E. D'Alfonso, co-sup. prof. Michele Moreno, Politecnico di Milano.
- 2007 Master's thesis: *New York City: a new horizontal image: figures of scales between territorial form and urban text*, stud. F. Monti, sup. prof. E. D'Alfonso, co-sup. prof. M. Moreno, Politecnico di Milano.
- 2007 Master's thesis: *New urban figures between architectural dimension and regional - geographical character*, stud. Claudia Zanoia, sup. prof. E. D'Alfonso, cosup. prof. M. Moreno, Politecnico di Milano.
- 2007 Master's thesis: *Ground writing between geographical thickness and urban text: Stratford City London*, stud. A. Gallo, N. Gerevini, sup. prof. E. D'Alfonso, co-sup. prof. M. Moreno, Politecnico di Milano.
- 2007 Master's thesis: *Geographical structure and urban form: Docklands Stratford City*, stud. Nicola Molinari, sup. prof. E. D'Alfonso, co-sup. prof. Michele Moreno, Politecnico di Milano.
- 2007 Master's thesis: *Urban ground: new layers and geomorphological morphologies: London Stratford City*, stud. Alfonso Vecchio, sup. prof. E. D'Alfonso, co-sup. prof. Michele Moreno, Politecnico di Milano.
- 2006 Master's thesis: *Between geographical tectonics and urban morphology: Segovia las Lastras, a new land for the city*, stud. Alessia Salandini, sup. prof. E. D'Alfonso, co-sup. prof. Michele Moreno, Politecnico di Milano, december 2006.
- 2006 Master's thesis: *A new centrality for Milan: interchange node and spaces connected to the new exhibition center*, stud. D. Prinzo, L. Rodolfi, sup. prof. E. D'Alfonso, cosup. prof. M. Moreno, Politecnico di Milano, july 2006.

Selected publications

- 2019 Moreno, M. (in press). *Grounds, Architecture between geographical continuity and autonomy*. Milano: Ed. Maggioli. Publishing ongoing
- 2018 Moreno, M., Di Franco, A., Orsenigo, G. (in press) *Open Architectural Didactic*. In *Call for Abstract and Paper, VII Forum Proarch Milano 2018*. ISBN 9788890905469
- 2018 Moreno, M. (2018). *Lo spazio scellerato. Verso l'architettura della detenzione*. In A. Di Franco, C. Gerardi, N. Guerrieri (Eds.), *La città oltre il muro* (pp. 54-65). Milano: Maggioli Editore. ISBN 9788891624895
- 2016 Moreno, M. (2016). *Geographical architecture Multi-scalar grounds in metropolitan growth of Teberan... the promise of Qaleh Morqi*. Unpublished manuscript
- 2014 Moreno, M. (2014). *Groundscape Geo- urban transcriptions and expanded archi-tectonics*. In A. Contin (Ed.), *Questo* (pp. 116-119). Milano: Maggioli Editore. ISBN: 978-88-916-0903-8
- 2013 Moreno, M. (2013). *Ri-tratto, per una fisiognomica della Val di Vara*. In E. D'Alfonso (Ed.), *Atti Convegno e Workshop L'arte di Costruire la Città Oggi*. Unpublished manuscript
- 2012 Moreno, M. (2012). *Fragile Landscape*. In A. Contin (Ed.), *Donana Out of the city* (pp.131-136). Milano: Maggioli Editore. ISBN: 9788838761469
- 2011 Moreno, M. (2012). *Urban Metabolism*. *Arc 2 Città, Urban Design, Interior Design, Architectural Design*, 0, 2-4. ISSN 2240-7553
- 2009 Moreno, M. (2009). *Studies for the integrated Castelvetrano-Selinunte intervention plan. Analysis, interpretation, maintenance, replacement and transformation*, original title: *Studio per il piano integrato di intervento Castelvetrano-Selinunte. Analisi, interpretazione, interventi di manutenzione, ricambio e trasformazione*. Milano, ITA: DASTU handle 11311/569489.
- 2007 Moreno, M., & Santamaria, G., (2007). *Effrazioni metropolitane: un progetto per New York*. In G. Santamaria (Ed.), *New York_Milano. Disegno per la città nella regione urbana* (pp. 92- 96). Firenze : Alinea. ISBN: 9788860551573
- 2007 Moreno, M. (2007). *Transcending generations and cultural projects ... urgencies and scripture - Tra-ire generazioni e progetti culturali...tra-ire urgenze e scritture*. In F. Purini, D. Nencini (Eds.), *Generazioni e*

- progetti Culturali. Atti della giornata di studio Facoltà di Architettura Valle Giulia* (pp. 309 – 312), Roma: Gangemi Editore. ISBN:9788849212112
- 2007 Moreno, M. (2007). *L'atto dell'immagine...scritture di suolo. Immagine-paesaggio-figura-azione*. In A. Contin, M. Sbacchi (Eds.), *Canicatti, campagne abitate, paesaggi d'arte* (pp. 116 – 119), Roma: Gangemi Editore. ISBN: 9788860552198
- 2006 Moreno, M., & Santamaria, G. (2006). *Il progetto tra svelamento e risignificazione di un territorio dimenticato*. In E. D'Alfonso (Ed.), *Milano Malpensa. La regione urbana nello spazio dei flussi* (pp. 100 – 105). Firenze: Alinea. ISBN: 8881258579
- 2006 Moreno, M., & Santamaria, G. (2006). *Entre los pliegues de un fluir geológico...en la rais del cambio*. In A. Contin (Ed.), *Segovia. Los altos de las Lastras* (pp. 78 – 93), Milano: A&P Editing. ISBN: 8881259664
- 2006 Moreno, M., & Laezza, R. (2006). *Sacred You. Multireligious Urban Center*. In F. Purini, N. Marzot, L. Sacchi (Eds.), *La città nuova. Italia-y-26. Invito a Vema* (pp.138 -145). Bologna: Editrice Compositori. ISBN: 9788877945242
- 2006 Moreno, M., & Laezza, R. (2006). *Sacred You. Multireligious Urban Center*. In F. Purini, N. Marzot, L. Sacchi, *Città.Architettura e società, Catalogo della X Mostra Internazionale di Architettura. Biennale di Venezia* (p.31). Venezia: Marsilio. ISBN: 9788877945242
- 2005 Moreno, M., & Santamaria, G. (2005). *Pratiche dell'immaginario e metodologie di progetto: letture critiche*. In A. Contin (Ed.), *Bari. Studi per la metropoli* (pp.97-102). Firenze: Alinea Editore. ISBN: 8881259664
- 2005 Moreno, M., & Santamaria, G. *Tra dislocazione critica e radicamento: un progetto per Bari*. In A. Contin (Ed.), *Bari Studi per la metropoli* (pp. 139–150), Firenze: Alinea Editore. ISBN: 8881259664
- 2004 Moreno, M. (2004). *Tra immagini e movimento. Il cluster come progetto contemporaneo inglese*. *Territorio*, 31, 120 -122. ISSN: 0327-3210
- 2004 Moreno, M., & Santamaria, G., Laezza R. (2004). *Terra Formless, Parametro*, 254, 78 – 85. ISSN: 0031-1731

Selected publications on projects

- 2018 Frontera, M. (2018, January 2). *Concorsi, la best practice del nuovo piazzale della stazione di Belluno*, Il Sole 24 Ore Edilizia e territorio.
- 2017 Reolon, M. (2017, December 16). *In Stazione la quarta piazza*, Corriere della Alpi.
- 2017 (2017, November 3). *Piazzale della Stazione: ecco i progettisti*, Il Gazzettino.
- 2012 Degli Esposti, L. (2011, March). *Manifesto adesione Spedizione dei Mille AUFO*. L'Arca. The international Magazine of Architecture Design and Visual Communication.
- 2007 Kalpakci, A. (2006, October). *Giovani architetti al Padiglione Italiano, Interview to Michele Moreno and Raffaella Laezza*, L'Universo.
- 2006 Milesi, G. (2006). *Mixmedia. Evento di Cultura elettronica di: new media art, architettura, sound/ audiovideo*
- 2006 Purini, F., Marzot, N., Sacchi, L. (2006). *Città.Architettura e società, Catalogo della X Mostra Internazionale di Architettura. Biennale di Venezia* (p.31). Venezia: Marsilio. ISBN: 9788877945242
- 2006 Fanelli, R. (2006). *X Biennale d'architettura, camminando nel futuro*, E-Artmagazine, 4, 2-4.
- 2006 Purini, F. (2006, May-June). *Dossier La Città nuova di VEMA. I progetti e il grande plastic*. *Paesaggio Urbano*, rivista di Architettura, Urbanistica e ambiente, 7, 1-15.
- 2006 Marotta A., Ruotolo P. (2006). *Arie Italiane. Motivi dell'architettura italiana recente*. Roma: Edil stampa. EAN: 9788878640221
- 2005 (2005). *Ephemeral Structure in Athens 2004*. Athens: Publication of the international competition Ephemeral Structure Athens 2004.
- 2004 Doumanis, O.B. (2004). *Design and Art in Greece*, 35, 24-27.
- 2004 Contin, A. (2004), *Segovia - Los altos de las Lastras* (pp. 78 – 93), Milano: A&P Exhibit.

2003 Schafer, R. (2003, march), *Topos – European Landscape Magazine*, 42, 10-12.

Selected projects Architecture and Landscape

- 2019 Theater Scene in *Teatro Farnese*, *Dodecaedro Terrea Motus*, with Martino Traversa *Polifonie*, Parma 2020, I. Ongoing
- 2018 Interior Design: *Piano nobile*. Palazzo Mazzucchi – Bevilacqua, piazza Ariostea Ferrara, I. Built
- 2018 International Design Competition: *Iconic Mosque at Dubai Greek Harbour*, Dubai, UAE. First phase
- 2018 Coordination executive project: pavilion *Traccia di Libertà*, Laboratory Architectural Design III Master's degree program, II Casa di Reclusione Milano – Bollate, I. Built and published
- 2018 International design competition: *New school of Lurago D'Erba*, Como, I. First phase
- 2017 International design competition in two phases: Redevelopment of the Station Square of Belluno, I. Finalist
- 2017 European Project: *Circular Economy* focused on the municipality of Taranto, II CALL U.I.A. (Urban Innovative Actions) Urban Lab of Europe, with DASTU Politecnico di Milano, I.
- 2017 International design competition: *Giardino delle Rimembranze*, Monumental Cemetery of Belforte-Varese, I. First phase
- 2017 Urban Project: *Variant of the Master Plan- PRG*, public spaces of the center of Salvarosa, with Mas arch. C. Pradel, Castelfranco Veneto, I. Adopted
- 2016 Interior Design: *Penthouse* in Piazza della Repubblica Milan, I. Built
- 2016 Interior Design: *Apartment in District City-Life*, Milan, I. Built
- 2016 Interior Design: *Apartment* in Barzio-Lecco, I. Built
- 2015 Urban Design: *Parma Città delle Muse*, with prof. arch. A. Contin. Pavilion EFSa with arch. F. Giulini e artist musician Martino Traversa in Parma, I (coauthors). Ongoing
- 2014 Urban Design: historical public garden of San Antonio in Salvatronda, with Mas arch. C. Pradel and arch. G. Pelloia (coauthors), Castelfranco Veneto, I. Built and published
- 2014 International design competition: *Guggenheim Museum Helsinki*, with coll. arch. M. Vescio, arch. F. Foschi, Helsinki, FL. First phase
- 2014 International design competition: *Padiglione Infanzia*, Milan, I. First phase
- 2014 Interior Design: Urban Center *Flexible Wall Concept's collection*. Milan, I
- 2014 Landscape design: *Wine Farm* in San Giovanni Ilarione, with MAs arch. C. Pradel Verona, I. Built
- 2013 International design competition: *Senior City in Cortina*, with. Mas arch. C. Pradel (coauthors), Belluno, I. First phase
- 2012 Architectural Design: Historical Building in Lecce, I. Built
- 2012 Architectural Design: *Penthouse* in Piazza Martiri- Belluno, I. Built
- 2011 Urban Design: *Technological Park Sphere*, In Capital Company with arch. S. Masotti (coauthors), Bergamo, I Concept Phase
- 2011 Urban Design: *UrbaNU, 10 progetti per Nuoro, New Campus University of the center of Sardinia*, with coll. arch. S. Caruso, Mas arch. C. Pradel, dott. S. M. Moreno, I. Published
- 2011 Exhibition Design Event: *Cariparma with A&S Incentive&Convention MIC Plus* in Milan, I.
- 2011 Exhibition Design Event: *Inter-disciplinary Yenikapı Symposium_ The future of the past of Yenikapı: trasfer point and archeological park*, Istanbul, TR. Built and published
- 2011 Urban Design: *AUFO Bridge - Bridge Italia-Tunisia*, with coll. arch. S. Caruso, arch. C. Pradel, dott. S. M. Moreno. Published and exhibited

- 2010 Urban Design: *MilanStadtKrone 2030, 15 archi-urban objects* with. S. Caruso, C. Pradel, M.S. Moreno Milan, I. Published and exhibited
- 2010 Exhibition Design Event: *The wine Club, Officine del volo* in Milan, I. Built
- 2009 International design competition: *DUBAI XI Thyssenkrupp Elevator Architecture Award - Tall emblem structure in Za'abeel Park*. Dubai, UAE. First phase
- 2008-09 Urban Design: *Master Plan of Castelvetrano*, with Politecnico di Milano DiAP, coordinator prof. arch. E. D'Alfonso, prof. arch. A. Contin, prof. arch. M. Sbacchi (coauthors). Adopted
- 2008 Architectural Design: *Yapi Kredi Academy* in Istanbul, TR with G. Santamaria e A. Contin (coauthors).
- 2007 International design competition: *Shenzhen Museum of Contemporary Art & Planning Exhibition*?, Shenzhen, China.
- 2007 International design competition: *New Bridge on the lake of Pertusillo*, I. First phase
- 2007 Urban Design: Research *PROGRESDEC* for European Community with DASTU, in Canicattì, I, Politecnico di Milano.
- 2007 International design competition: *European 9, Urbanità Europea, città sostenibili e innovazione degli spazi pubblici*, Carbonia, I. First phase
- 2007 International design competition: *New York Museum Tower* in Manhattan, USA. First phase
- 2006 International design competition: *Tres Itinerarios Urbanos en Madrid OCAM Oficina de Concursos de Arquitectura de Madrid* with proff. P. Ortiz, E. D'Alfonso, A. Contin, C. Dionisi, L. Mussi (coauthors). Madrid, E. Third prize and published
- 2006 Urban Design: *Sacred you. Multireligious Urban Space, X Mostra Internazionale di Architettura, Biennale di Venezia, "TALLA-y-2026. Invito a VeMa"* by F. Purini, with R. Laezza (coauthor), artist: Giovanna dal Bon, invited architect P. Eisenman, coll.: A. Casarotto, A. Cosatti, V. D'Osualdo, A. Trolese, A. Sammartino, V. Glicinetti, M. Orlandini. Exhibited and published
- 2005 International Design competition: *Nuovo polo giudiziario a Trento* (Collaboration) with P. Eisenman (Team leader), R. Laezza, G. Zuliani, L. Semerani. Trento, I. Exhibited and published
- 2005 International design competition: *Seoul Performing Art Center*, Seoul, KR. First phase
- 2004 International design competition: *Federico Garcia Lorca Foundation*, with R. Laezza, G. Santamaria (coauthors). Granada, E. Exhibited and published
- 2004 Urban Design: *Los Altos de las Lastras*, Ph.D Research coord. prof. Ernesto D'Alfonso Politecnico di Milano with G. Santamaria (coauthor). Segovia, E. Exhibited and published
- 2004 Urban Design: *Olympic Village Olympic Games 2012*, in Queens NYC Ph.D Research coord. prof. Ernesto D'Alfonso Politecnico di Milano.
- 2004 International Design competition: *Nuovo Stadio Comunale* in Borgo Vecchio. Siena, I. Published
- 2003-04 Landscape Design: *Parco del sapere*, Oxford, GB. Ph.D Research coord. prof. Ernesto D'Alfonso Politecnico di Milano with G. Santamaria (coauthor). Oxford, UK. Exhibited and published
- 2003 Urban Design: Research M.U.R.S.T. *Lo Spazio dell'Ecclesia in Nuove Architetture e servizi per lo sviluppo sostenibile delle aeree metropolitane: Venezia Mestre-Terraglio*, with arch. R. Laezza, arch. G. Santamaria. Published
- 2003 International design competition: *Landmark Tower & U2 Studio*, Dublin, IRL, with arch. G. Santamaria, S. Masotti (coauthors). Dublin, IRL. Published
- 2003 Video Art: *Video Blurred Zones -Trilogy* in *50th International Exhibition of Art La Biennale di Venezia - Utopia Station*, with arch. R. Laezza, arch. G. Santamaria (coauthors). Venice, I.
- 2002-03 International design competition: *Ephemeral Structures in the city of Athens: Open-Air Theatre, Olympics Games 2004*, with arch. G. Santamaria (coauthor). Athens, GR. First prize and published
- 2002 International design competition: *Piazza Italia in Kobe*, with arch. R. Laezza, arch. G. Santamaria, A. Cedolini (coauthors). Kobe, J. Third prize and published

- 2001 Landscape Design: *River's Piave Park*, San Donà di Piave, with arch. G. Santamaria (coauthor). Venice, I. First prize and published
- 2001-06 Experimental Drawings: *Stati iniziali*.

Selected Exhibitions

- 2018 *Fondazione Architettura Belluno Dolomiti*, International design competition in two phases, Redevelopment of the Station Square of Belluno. Belluno, I
- 2017 Palazzo Comunale di Varese, via Sacco n°5. International design competition *Giardino delle Rimembranze*, Monumental Cemetery of Belforte. Varese, I
- 2015 International, *Guggenheim Museum Helsinki*, spring 2015. Helsinki, FL
- 2012 Isisuf - Istituto Internazionale di Studi sul Futurismo, Piazza Aspromonte 11. Project: *Infrastructurban*. Milan, I
- 2011 Isisuf - *Istituto Internazionale di Studi sul Futurismo*, Piazza Aspromonte 11. Project: Urban Design entitled *AUFO Bridge - Bridge Italia-Tunisia*. Milan, I
- 2010 Isisuf - *Istituto Internazionale di Studi sul Futurismo*, Piazza Aspromonte 11, Milan. Project: *MilanStadtKrone 2030, 15 archi-urban objects*. Milan, I
- 2010 *Inter-disciplinary Yenikapi Symposium The future of the past of Yenikapi, transfer point and archeological park*. Istanbul, TR
- 2007 Bovina Politecnico di Milano. Project: *Sacred you. Multireligious Urban Space in VEMA*. Milan, I
- 2007 *Palazzo Mutinati*, by F. Purini
Project: *Sacred you. Multireligious Urban Space in VEMA*. Verona, I
- 2007 Project: *80 ideas for the Bridge of Pertusillo*. Potenza, I
- 2006 *Mixedmedia* by arch. Gianluca Milesi. Milan, I
- 2006 *X Mostra Internazionale di Architettura della Biennale di Venezia, CITTA'. Architettura e società* by Richard Burdett. Project exhibited: *Sacred you. Multireligious Urban Space in VEMA*. Venice, I
- 2005 *Sala Murat*. Project: *Bari studi per la Metropoli*. Bari, I
- 2004 Project: *Ephemeral Structures in the city of Athens: Open-Air Theatre*, Olympics Games 2004. Exhibition: *NIB+ICAR Traveling Exhibition* in: Bari, Cagliari, L'Aquila, Como, Reggio Calabria, Barcellona, Cortina, Roma, Paris (Fondation Hellenique), Lamia, Herakleion, Athens, London (Riba Gallery Royal Institute of British Architecture).
- 2004 *Los Altos de las Lastras*. city Hall Municipality of Segovia, E
- 2003 *Video in 50th International Exhibition of Art La Biennale di Venezia – Utopia Station*. Project entitled *BLURRED Zones _Trilogy*. Venice, I
- 2002 Project: *Piazza Italia in Kobe*", Kobe, J.
- 2001 Project: *River's Piave Park of San Donà*. Venice, J

Video on city and landscape

2013	Val di Vara, I	<i>val di vara</i>	10'00"
2012	Palanzano, I	<i>valli dei cavalieri</i>	10'00"
2011	Yenikapi, Istanbul, Tr	<i>Yenikapi</i>	6'00"
2010	Donana, Spain	<i>atorce veces mil</i>	6'30"
2009	Cadice, Spain	<i>dos mil cuatrocientos metros</i>	12'00"
2008	Sicily, Italy	<i>castelvetranoselinunte</i>	14'00"

2007	Paris, France	<i>Donors, paris</i>	40'00"
2005	Bari, I	<i>mille metri tra terra e mare</i>	6'33"
2005	Belluno, I	<i>MDB, Mario De Biasi</i>	4'44"
2004	Segovia, Spain	<i>Las Lastras</i>	6'33"
2003	Brindisi, I	<i>Attraversamenti</i>	6'00"
2003	Venice, I	<i>Blurred Zones trilogy</i>	3'33"
2003	New York, Usa	<i>Next stop...Vernon Blvd</i>	4'33"
2002	Venice, I	<i>Indicativo...presente</i>	6'00"
2002	Kobe, Japan	<i>0004EU</i>	2'00"
2001	Matera, I	<i>Trasversalità</i>	6'00"
2000	S.Donà di Piave, I	<i>Toccamì and Non Esiste</i>	3'00" + 3'00"

Concept art

- 2001-16 New York, Madrid, Oxford, Milano: series Urban prints, white ceramic (60x60cm; 20x20cm)
- 2001-06 *STATI INIZIALI: Drawings*
- 1999 Italy-France , International Competition in Paris VI Prize of Painting *les Trophées de la couleur*. Work exhibited *la faim* (acrylic on canvas, 70x100 cm)
Finalist

Lugano, july 11st, 2019

Michele Moreno



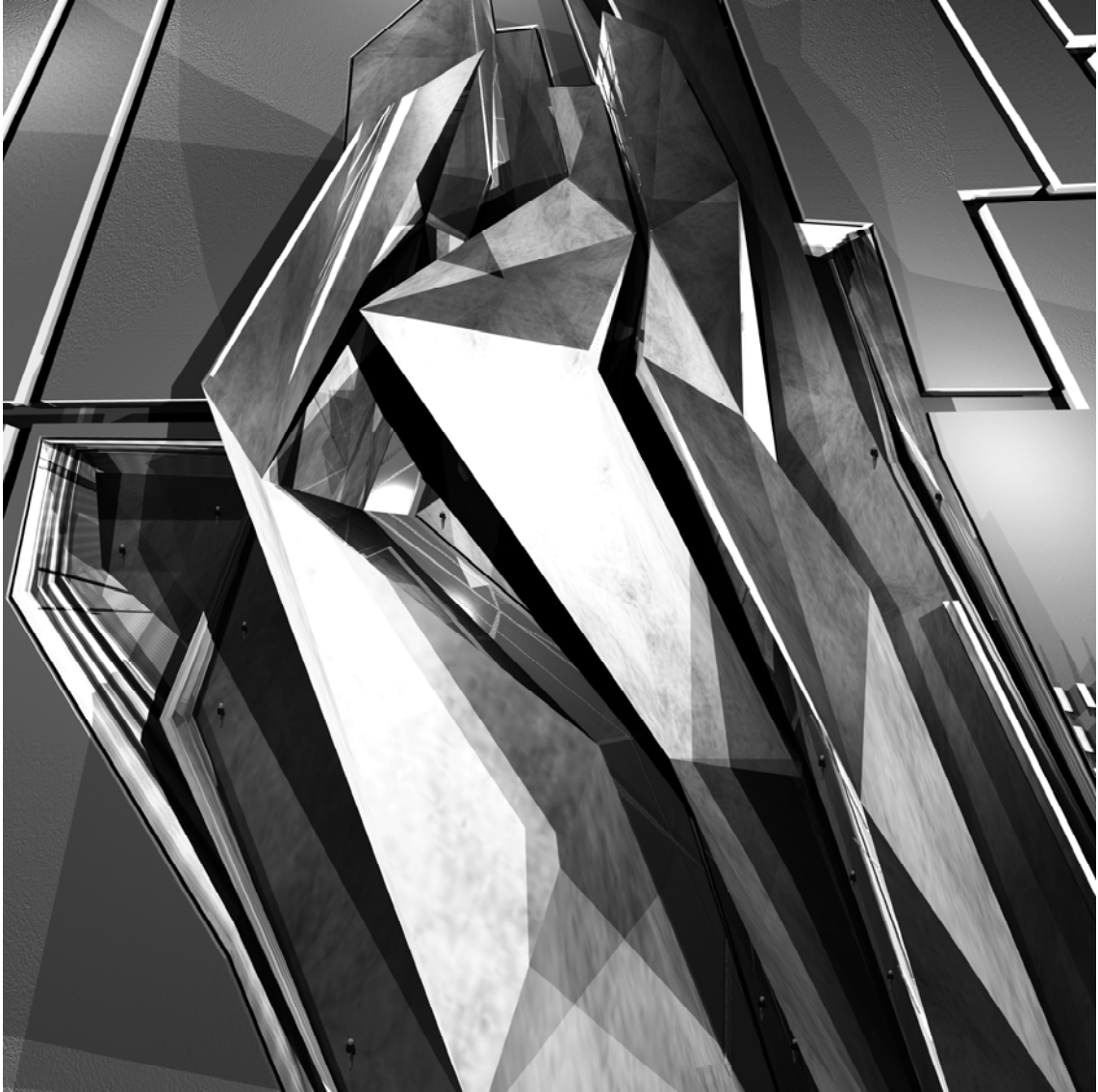

2011. *Sphere*, Technology Park, Bergamo